

1. 試求長 40ft 之簡支梁承受圖示活動集中荷重之絕對最大彎矩。

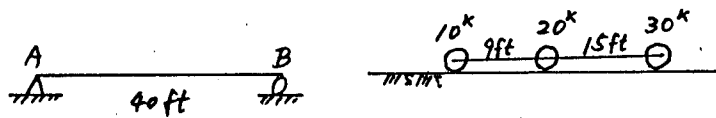

2. 圖示桁架若每一桿件均伸長 $\frac{1}{8}$ in., 試求 C 點之水平及垂直位移。

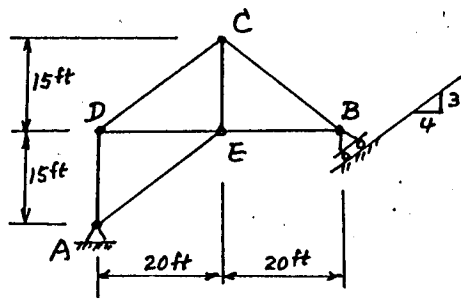

3. 試用斜角撓度法 (Slope - Deflection Method) 求 B 點水平位移。

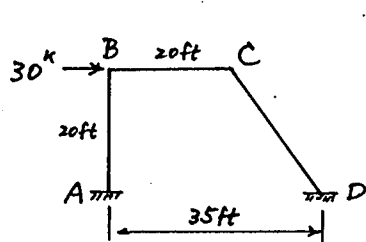

$$EI = 3 \times 10^6 \text{ kip-in}^2$$

4. 試求下圖超靜定桁架各節點位移及桿件應力。(方法不限)

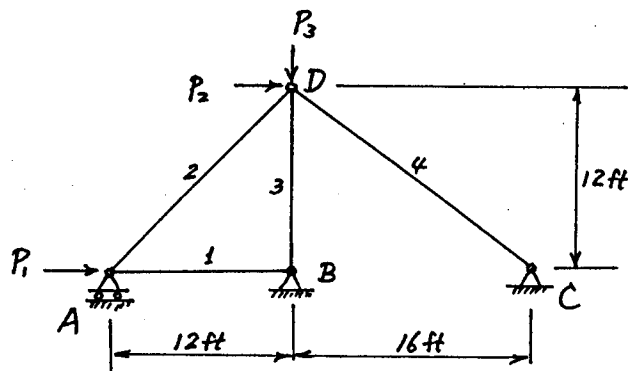

$$P_1 = 10 \text{ kips}$$

$$P_2 = 20 \text{ kips}$$

$$P_3 = 15 \text{ kips}$$

$$EA = 2 \times 10^5 \text{ kips}$$